



Safety instructions / Instrucciones de seguridad

Precautions / Precauciones:

It is important that you read, fully understand and observe the following safety instructions as well as the installation instructions.
Careless or improper handling may cause injury or property damage.



*Es importante que lea, comprenda completamente y respete las siguientes instrucciones de seguridad, así como las instrucciones de montaje.
El manejo descuidado o inadecuado puede causar lesiones o daños a la propiedad.*

Good footwear is very important. Wear sturdy boots with nonslip soles. Steel-toed safety boots are recommended.



Un buen calzado es muy importante. Póngase botas gruesas con suela antideslizante. Recomendamos las botas de seguridad con puntera de acero.

Knee-protection is recommended!



¡Recomendamos la protección de rodilla!

Always wear gloves when handling and installing the mats. Heavy-duty, nonslip gloves improve your grip and help to protect your hands.



Siempre use guantes cuando maneje y monte los pisos de goma. Los guantes gruesos y antideslizantes mejoran el manejo y ayudan a proteger las manos.

During installation / durante el montaje:

Do not stand or work under suspended load (pallet)!



¡No se pare ni trabaje bajo carga suspendida (palet)!

- Do not underestimate the weight of the mats. Improper handling may cause injury.
- Only use the recommended tools.
- Observe the safety instructions of the tools' manufacturers.
- Caution when cutting: blade may move quickly through the rubber mat. Be sure you are cutting away from your body.
- Pallets can be broken! Watch out for splinters and / or nails!
- Take care to remove edge protectors or other small parts of packaging from cow feeding areas!



- *No subestime el peso de los pisos de goma. El manejo inadecuado puede causar lesiones.*
- *Solo use las herramientas recomendadas.*
- *Respete las instrucciones de seguridad de los fabricantes de herramientas.*
- *Tenga cuidado al cortar: la cuchilla puede moverse rápidamente a través del piso de goma. Asegúrese de estar cortando lejos de su cuerpo.*
- *¡Los palets se pueden romper! ¡Cuidado con las astillas y / o los clavos!*
- *¡Tenga cuidado de quitar los protectores de bordes u otras partes pequeñas de los envases de las áreas de alimentación de las vacas!*

After installing / después del montaje:



Caution!
Cows will be more active!

*¡Cuidado!
¡Las vacas podrían ser más activas!*



Watch out for uneven edges if the floor is only partially covered.

Tenga cuidado con los desniveles en los bordes si el piso está cubierto solo parcialmente.



Residues on the rubber may cause slippery condition while and shortly after installing!

¡Los residuos sobre la goma pueden causar condiciones resbalosas durante y poco después del montaje!

KRAIBURG KEW Plus

Requirements:



concrete area:

- smooth
- clean
- minimum 3 % slope

mats:

Installation Temperature:
minimum 41°F (5°C) to maximum 86°F (30°C) (be sure internal temperature of mats falls within above range)



for animal hygiene some bedding is necessary to absorb moisture

You will need this:

measuring:

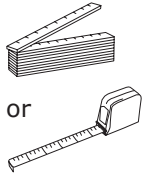

marking:

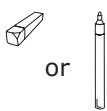

cutting:

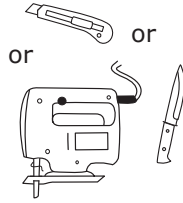

drilling and installing:

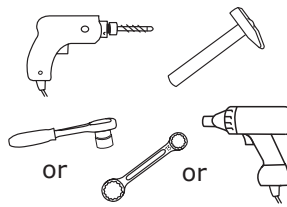

fastening components:

- 3/8" x 4" LDT steel anchors
 - 1/2" x 1-1/2" fender washers
- (or fastening components with at least the same resistance and durability)

mat width:

42"

mat width:

44"

mat width:

44"

connector bar width:

3-1/2"

3-1/2"

5-1/2"

7-1/2"

9-1/2"

stall width:

45-1/2"

47-1/2"

49-1/2"

51-1/2"

53-1/2"

Do not stack the pallets!



Please verify mats are assembled correctly as they are taken off the pallet

1 Lay out mat row completely and set distances using the spacing gauge

- make a mark 1" (3 cm) from the edge of rear curb along the entire length of the stall row
- start from the middle of the stall row and install to the right and to the left
- center the lower mat between dividers so connector bar will lay beneath stall divider



tip: when installing / ordering calculate with additional 1/4" (4 mm) per mat and e.g. lay out every 12th lying place 2" (5 cm) smaller

KRAIBURG-Logo facing up

open cups facing up

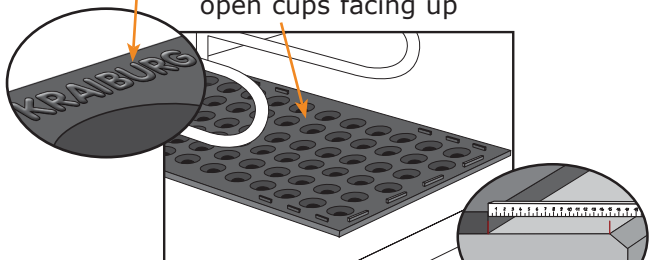

lay out lower mat

distance from mat to curb edge: 6" (15 cm)

positioning ribs

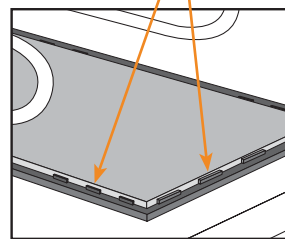

insert foam within the positioning ribs

be sure pilot holes run along front of stall

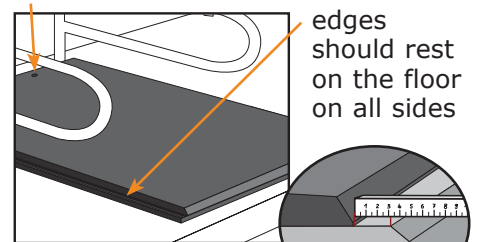

put upper mat over lower mat and foam

edges should rest on the floor on all sides

distance from mat to curb edge: 1" (3 cm)

lay out remaining mats:

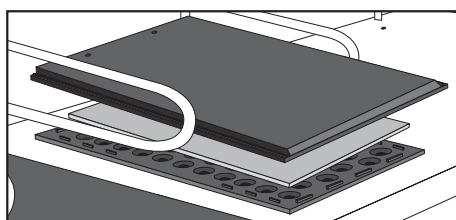

connector bar sits under the stall divider

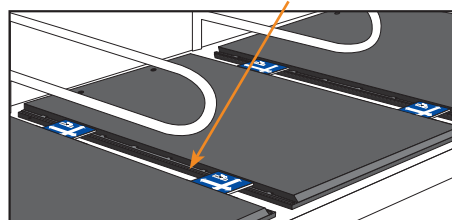

set distance between mats using spacing gauge

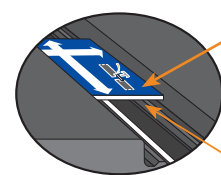

place spacing gauge approx. 8" (20 cm) from end of mat

Appropriate installation may differ due to local conditions. Therefore the manufacturer is not liable for installation!



② Insert connector bars

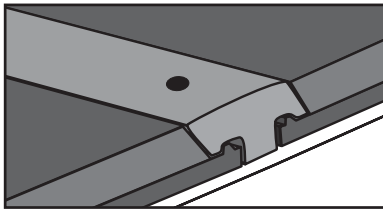

- chamfered side to rear
- connector bar should be flush with end of mat, no overhang

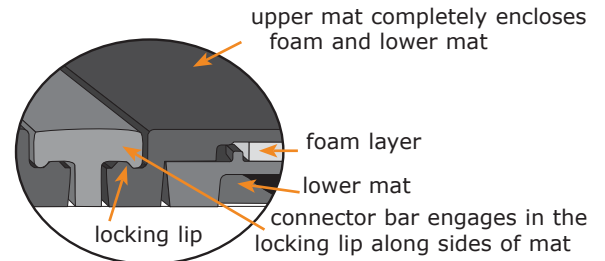

③ Fasten connector bars using 5 anchors, but do **not** tighten completely!

Please Note: No washers are necessary when installing connector bars

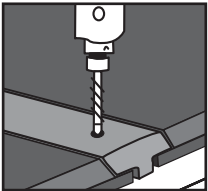

drill

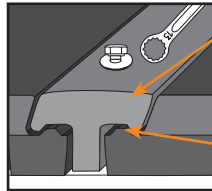

turn in LDT's loosely, do not fasten tightly yet!

connector bar engages in the locking lip along sides of mat

locking lip

tip: for installing connector bar

1. drill first hole
2. turn in LDT loosely
3. then continue on to remaining four holes

After entire row of KEW Plus is laid out and fixed loosely:

④ Finish fastening connector bars and mats

A fasten connector bars completely

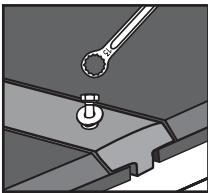

B fasten mats at front edge in designated pilot holes

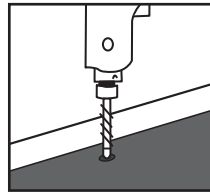

drill

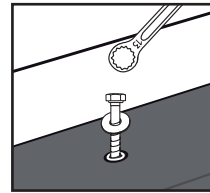

fasten 3/8" x 4" LDT steel anchor and 1/2" x 1-1/2" fender washer

! fasten screws until they are seated evenly fast and are slightly countersunk.
Do not overtighten!

⑤ Finish row with termination bar or anchors

with termination bar:

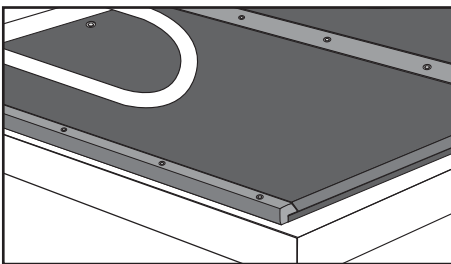

fasten termination bar

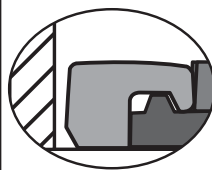

Minimum 1/4" (0.5 cm) from wall

or with no termination bar:

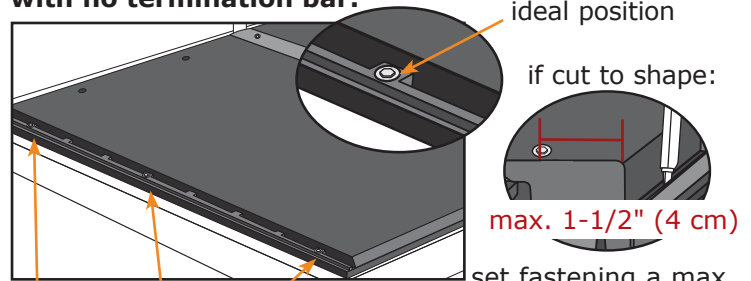

fasten edge of upper mat with three 3/8" x 4" LDT steel anchors

set fastening a max. 1-1/2" (4 cm) away from the upper mat edge

Mushroom dividers

upper mat:

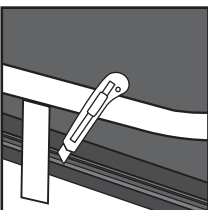

locking lip can be cut in up to 1" (3 cm)

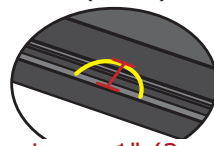

maximum 1" (3 cm)

connector bar:

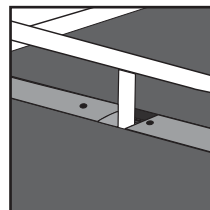

if required, divide the connector bar to fit on either side of pipe and add additional anchors

! for cutting the connector bar use a handsaw or a handheld circular saw

! **important:** connector bar must cover entire length of mat (also with mushroom dividers)

Appropriate installation may differ due to local conditions. Therefore the manufacturer is not liable for installation!



KRAIBURG KEW Plus - US - 2/2019 - I