

## KRAIBURG PORCA relax S

### prerequisites:



#### slatted floor elements:

- fit together  
-> max. 3 mm height offset (vertical distance)
- load bearing capacity is ensured
- slit width: 15 - 21 mm

#### walls:

mat row is delimited with walls on **three sides!**

#### mat temperature:

even mat temperature:  
**15 - 25° C**

#### KRAIBURG

#### fastening elements:

- connection pins
- slat anchor for slit widths: 15 - 17 mm or 18 - 21 mm

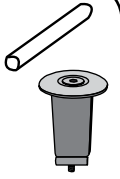

### You will need this:

#### measuring:

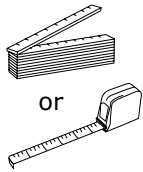

#### marking:

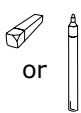

#### cutting:

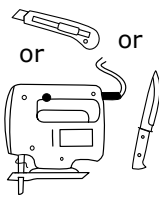

#### drilling:

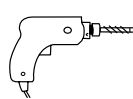

#### pounding in connection pins:

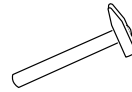

#### punching fastening holes:

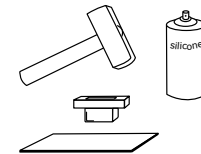

#### installing slat anchors:

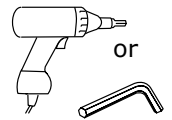

## 1 Drilling and inserting connection pins (5 holes/connection pins per side)

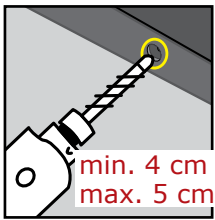

drilling (steel drill  
Ø 12 mm)

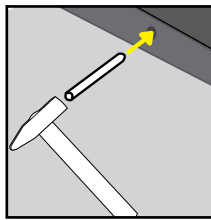

pound connection pins into the mat

**!** drill into the **pre-fabricated countersinks!**

## 2 Lay out mats, pin and connect them

**i** place the first mat flush to the edge

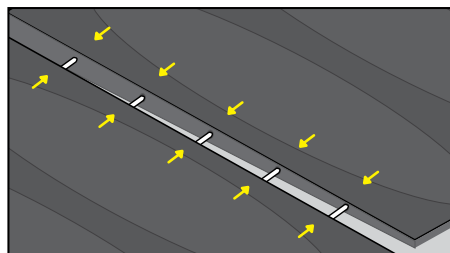
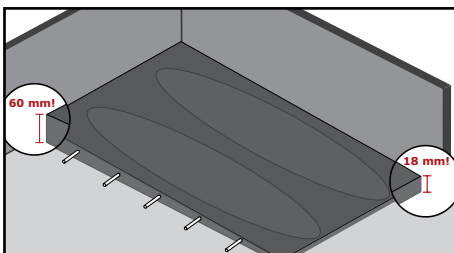

plug the mats together with the connection pins

**!** Avoid joints!

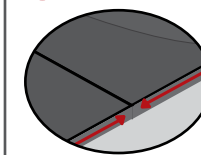

**PRESS MATS SLIGHTLY TOGETHER!**

## 3 Adaptation

If necessary, cut mats to shape and fit them in

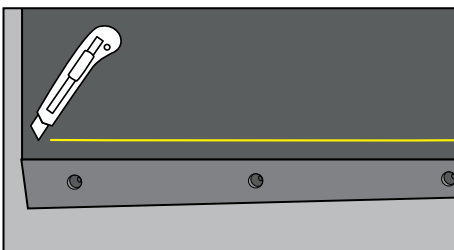

mark the mat to fit and cut it

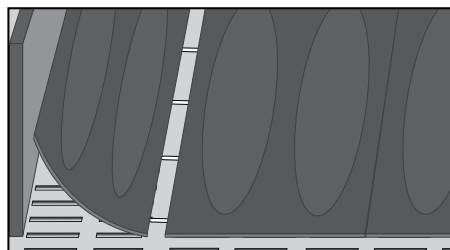

fit mat piece in and pin mats together

## ④ Fastening mats

On slatted floor with KRAIBURG slat anchor

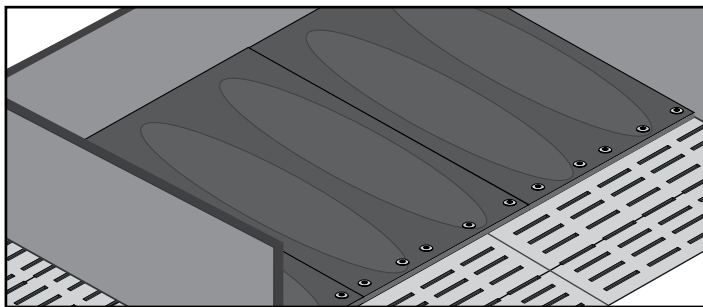

Fasten mats on the open ridge with 5 slat anchors each

### Ⓐ Punch in fastening holes with punching tool

punching tool, silicone spray, punching pad

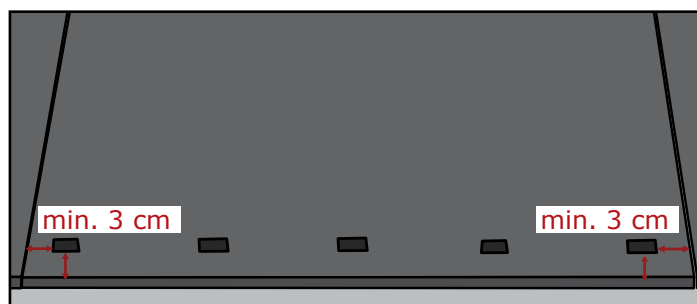
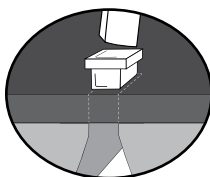
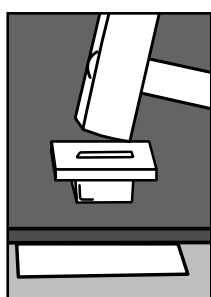
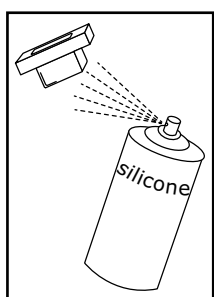

! slat anchors may not be fastened in the slit between two floor elements.  
-> slat anchor is possibly not lodged tightly enough and might be pulled out

If this can not be avoided:  
place **additional fastening** into the next slit at the mat edge

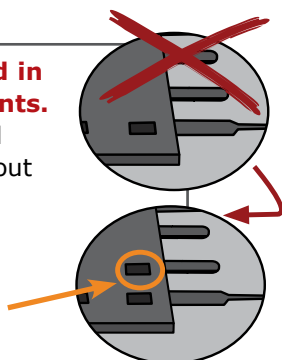

! place fastenings **as close as possible** towards the edge, but leave **at least a 3 cm** distance towards each **edge!**

### Ⓑ Fastening

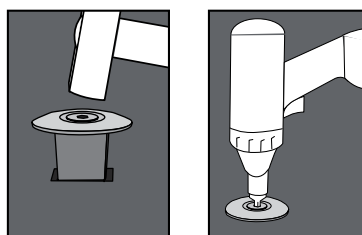
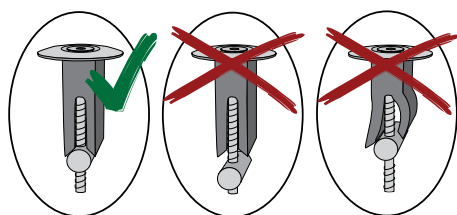

! fasten slat anchor tightly!  
**do not overtighten!**

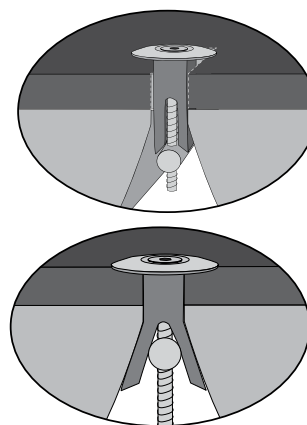

! installation on paved floors with KRAIBURG nail plugs:  
drilling and fastening see installation instructions PORCA relax U!

Appropriate installation may differ due to local conditions.  
Therefore the manufacturer is not liable for installation!



KRAIBURG PORCA relax S - 04/2013 - I