

## KRAIBURG KEW Plus

### prerequisites:



#### concrete area:

- no holes
- no elevations
- with at least a 3 % slope

#### mats:

even temperature: minimum 5° C to maximum 30° C (store according to initial temperature)

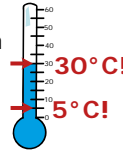

for animal well-being some litter is necessary to absorb moisture (e.g. soft milled straw or mineral material)

### You will need this:

#### measuring:

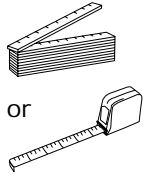

#### marking:

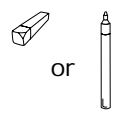

#### cutting:

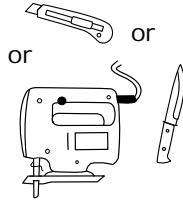

#### drilling and installing:

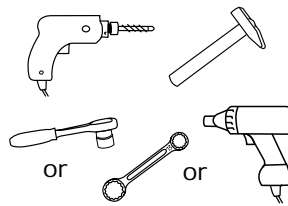

#### KRAIBURG fastening elements:



- framing plugs ø 10 x 100 mm with
- hexagon screw (SW 13) - A2
  - washer ø 30 mm - A2

(fastening elements are part of delivery)

mat width:	107 cm	112 cm	112 cm	112 cm
profile width:	+ 8 cm	+ 8 cm	+ 13 cm	+ 18 cm
cubicle width:	115 cm	120 cm	125 cm	130 cm



**Do not stack the pallets!**  
**please note:** the position of the mats on the pallets is standardly NOT the right position for the installation!

## 1 Lay out mat row completely and set distances by means of assembling tool

- first mark a 3 cm distance from the rear concrete edge along the whole length of the cubicle row
- start from the middle of the cubicle row and install to the right and to the left
- for the correct position of the profile under the divider (**+/- 6 cm**) notice that the mat width usually is at the upper tolerance level.

**tip:** when installing / ordering calculate with additional 4 mm per mat and e.g. lay out every 12<sup>th</sup> lying place 5 cm smaller

KRAIBURG-Logo on upper side  
 open cups on upper side

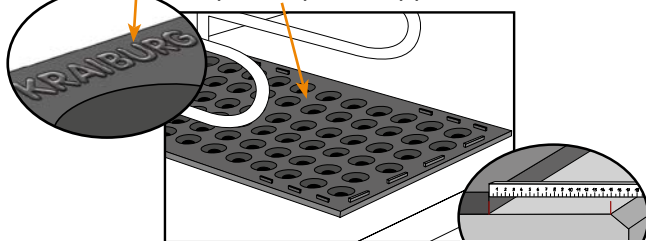

lay out lower mat

rear concrete edge: minimum 15 cm distance!

positioning bars

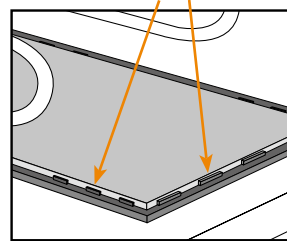

insert foam within the positioning bars

fastening holes on the front edge

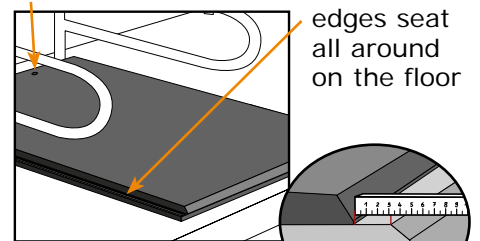

put upper mat over it

edges seat all around on the floor

rear concrete edge: minimum 3 cm distance!

lay out more mats:

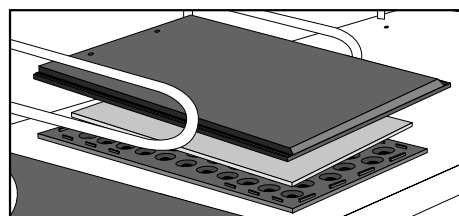

profile is more or less under the divider (maximum +/- 6 cm)

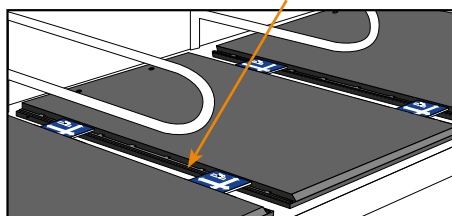

to install loosely set distance between mats by means of the assembling tool (wider than profile)

indent assembling tool approx. 20 cm



## ② Insert profiles

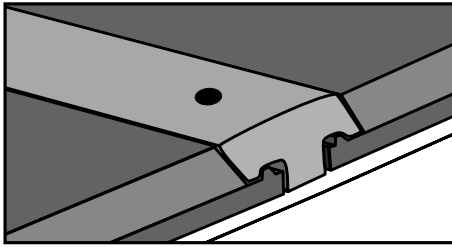

- chamfered side to rear
- flush with the rear mat edge

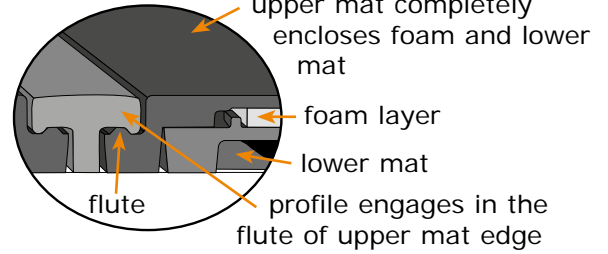

## ③ Fix profiles 5 x, but not yet tighten fast

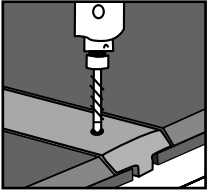

drill

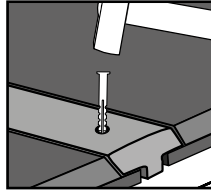

pound the plastic plugs in flush

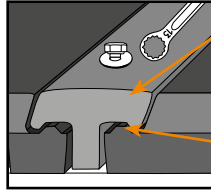

turn in screws and washers loosely, not yet fasten tightly

profile engages in the flute of the mat edge

flute

**tip:**  
avoid profile slippage:  
1. drill first hole  
2. pound in a plug (-> fixation)  
3. afterwards drill further holes and so on

When the whole lying mat row is already laid out and fixed loosely:

## ④ Fasten profiles and mats

**A** fasten profiles 5 x

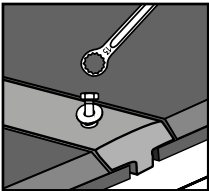

finally fasten all pre-assembled screws

**B** fasten mats at front edge 2 x

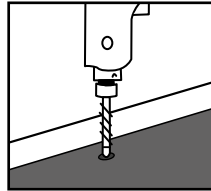

drill

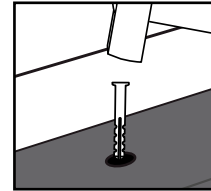

pound the plastic plugs in flush

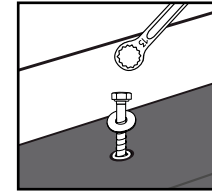

fasten screws and washers

**!** fasten screws until they are seated evenly fast and are slightly countersunk.  
**Do not over-tighten!**

## ⑤ Fasten last side mat edge

with "end"-profile:

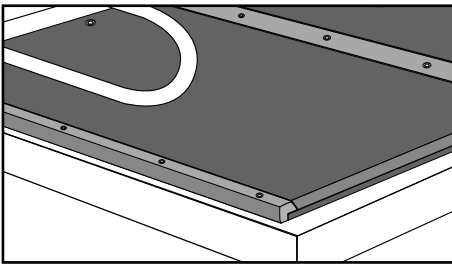

fasten with "end"-profile

or with no profile:

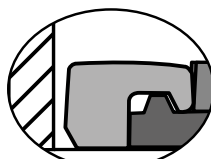

minimum 0.5 cm distance to the wall

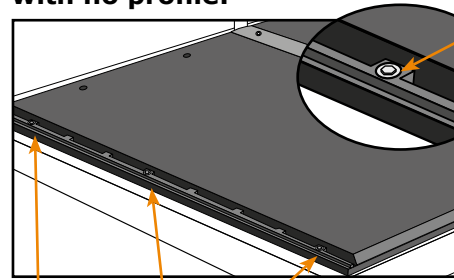

fasten edge of upper mat with 3 fastening elements

ideal position if cut to shape:

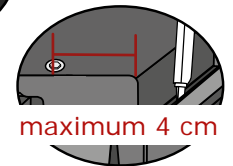

maximum 4 cm

set fastening max. 4 cm away from the upper mat edge

## Mushroom dividers

upper mat:

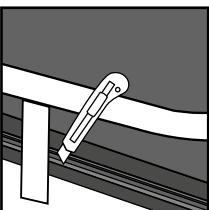

thinner side edge can be cut in up to 3 cm

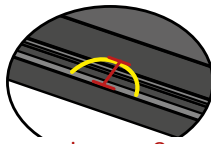

maximum 3 cm

profile:

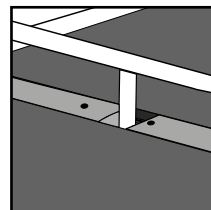

if required, divide the profile, adapt it and **fasten additionally**

**tip:** for adapting the profiles a handsaw or a handheld circular saw is suitable

**!** important: profile covers the joint over the whole mat length (also with mushroom dividers)